

Acoustek

E: sales@acoustek.com.au

Ph: +61(0) 418 792 788

Web: www.acoustek.com.au

Opus Pergola series Acoustic Blades

Installation Guide



Componentry Overview

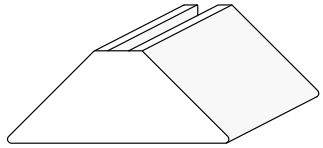

Aluminium Extrusions
(quantity varies)

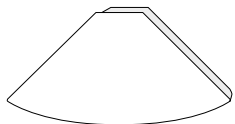

End Caps
(quantity varies)



MD003 Chassis rails (quantity and sizes vary)



MD001 Blades (quantity and sizes vary)



MD001 End Blades (quantity and sizes vary)

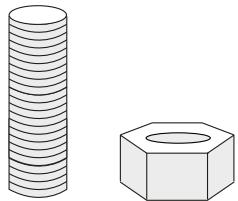

x4 of M6, 10mm Grub Screws
x8 M6 nuts

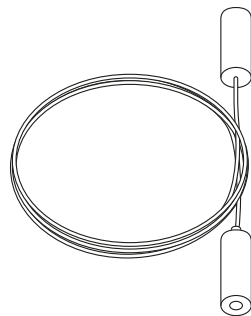

4 x Suspension wire kits

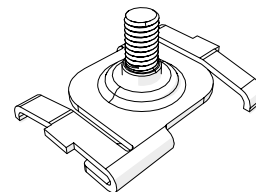

x4 T-Grid clips

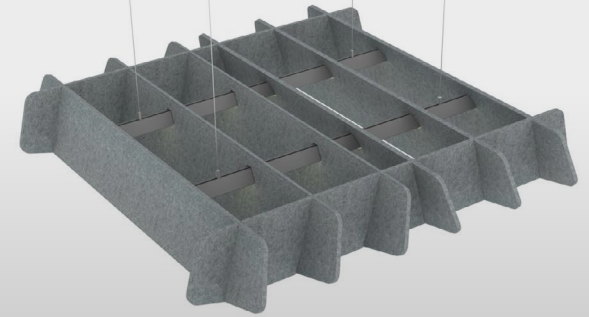

1200 X 1200MM

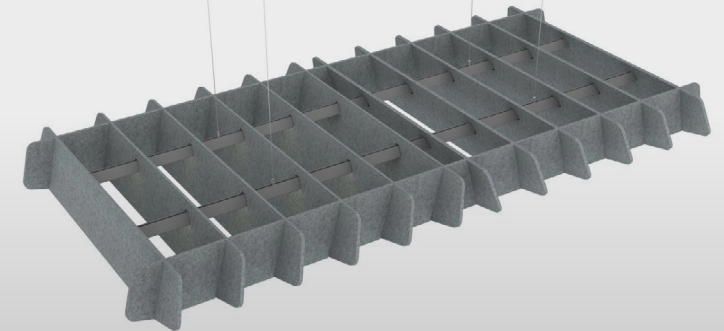

1200 X 2400MM

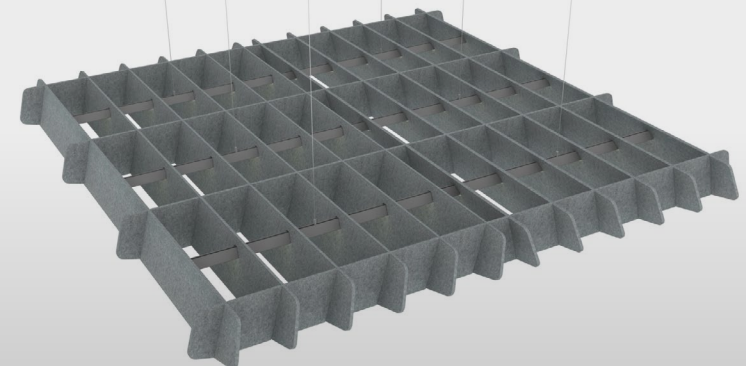

2400 X 2400MM

Assembly (1 of 2)

1. Assemble as per diagram all MD001 Blades into the relevant mating slots of both MD003 Chassis rails

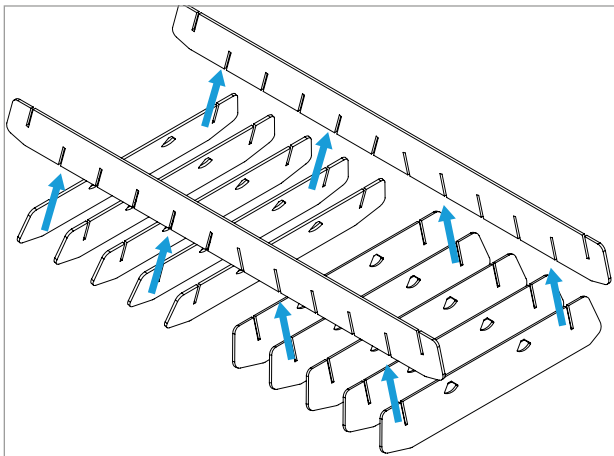

2. Slide 1 x MD001 End Blade into the relevant mating slots one end of the Chassis rails

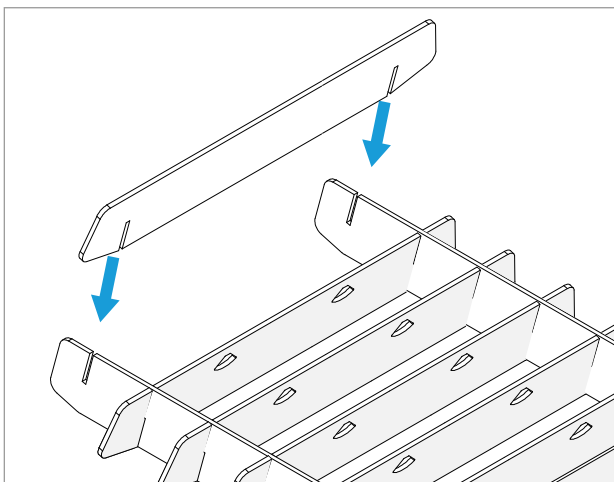

3. Each Opus extrusion and diffuser assembly to now have 2 x M6 nuts slid into place along the top slot of the extrusion, these will be eventually positioned 300mm from each end of the 1200mm extrusion or 600mm from the ends in the 2400mm extrusion version.

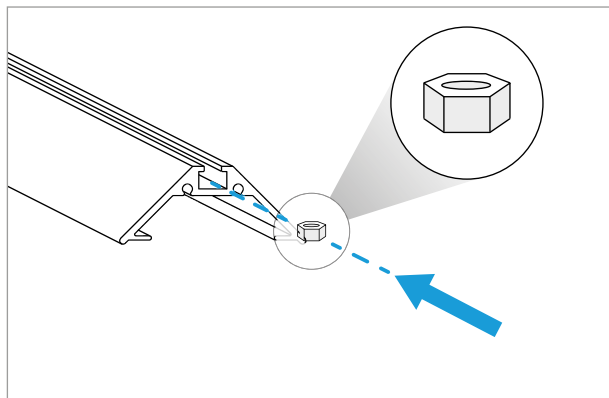

Place end caps onto the extrusion.

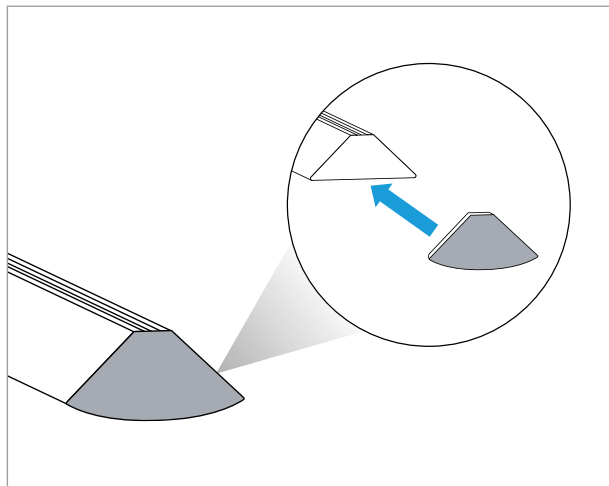

Each extrusion assembly can now be slid into position via corresponding shaped cut-outs in each of the centre blades.

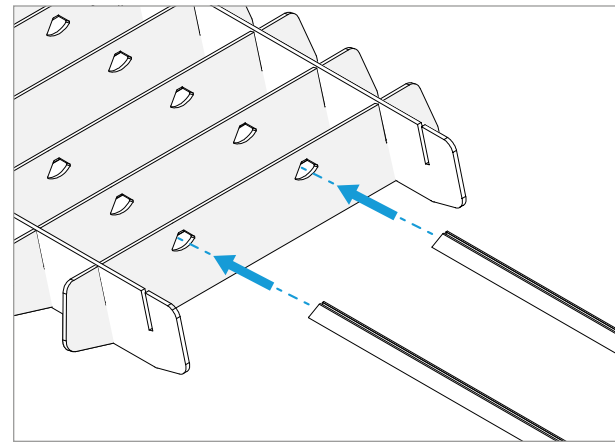

4. Slide the second MD100 End Blade into the Chassis rail end location to prevent the extrusion movement.

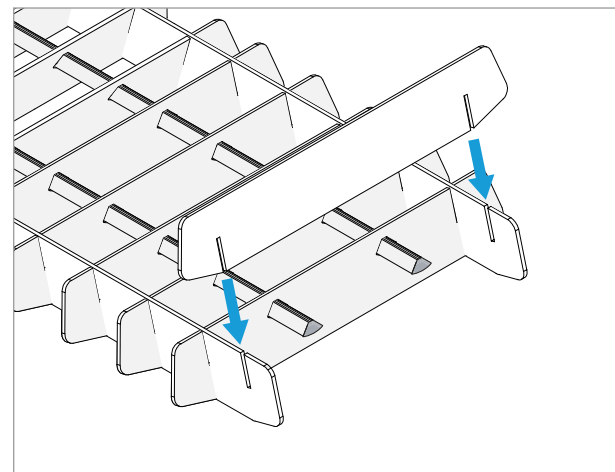

Assembly (2 of 2)

5. Locate the M6 nuts to their relevant position and lock by use of the M6 x 20 grub screws and lock grub screws into place with additional M6 nuts as needed.

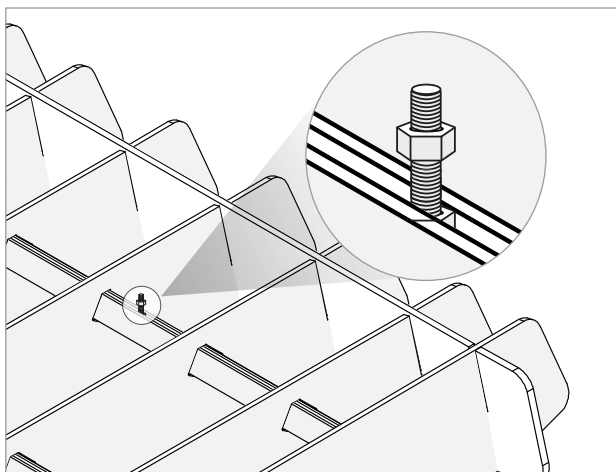

Screw the 4 barrel cable sliders onto each of the protruding grub screws, each barrel adjuster accepts each of the 4 suspended S/S wires and allows height adjustment of the assembly.

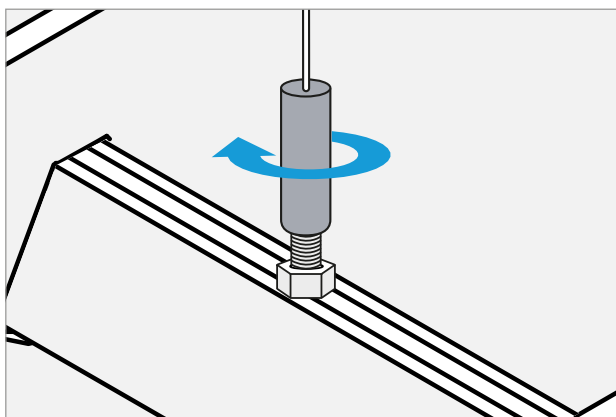

6. Locate the 4 x suspension wires into the ceiling grid using M6 cable retainer sleeve and M6 T grid clips provided - attached to the grid at relevant points taking care to plan the suspension positioning of the blades to compliment the workstation or furniture beneath:

- 1200 x 1200 system suspension wires in 600mm square suspension
- 2400 x 1200 system “ “ 1200mm x 600mm suspension
- 2400 x 2400 system “ “ 1200mm x 1200mm suspension

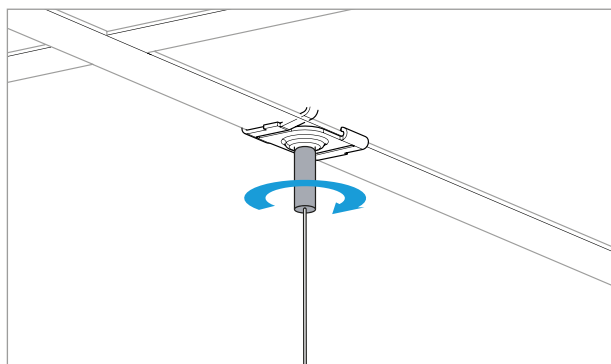
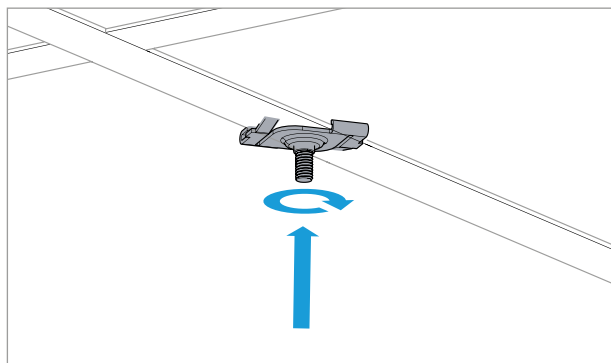

7. x2 person lift of the system to insert each wire into the corresponding barrel cable sliders on each extrusion, once each cable inserted, lift the assembly in unison to the required height systematically adjusting the cables to allow system suspension at the chosen height.

Fine tuning of height can be done by depressing the outer flange of the barrel adjuster to release the cable.

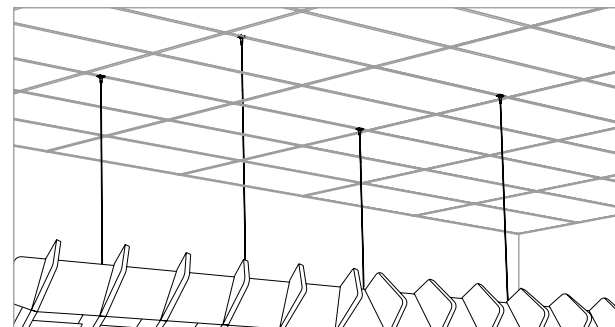

8. DO NOT cut the excess S/S wire but feed same along the slot of the extrusion to enable adjustment and/or reusage/relocation when desired.

